

The Centennial Centre Ground Floor

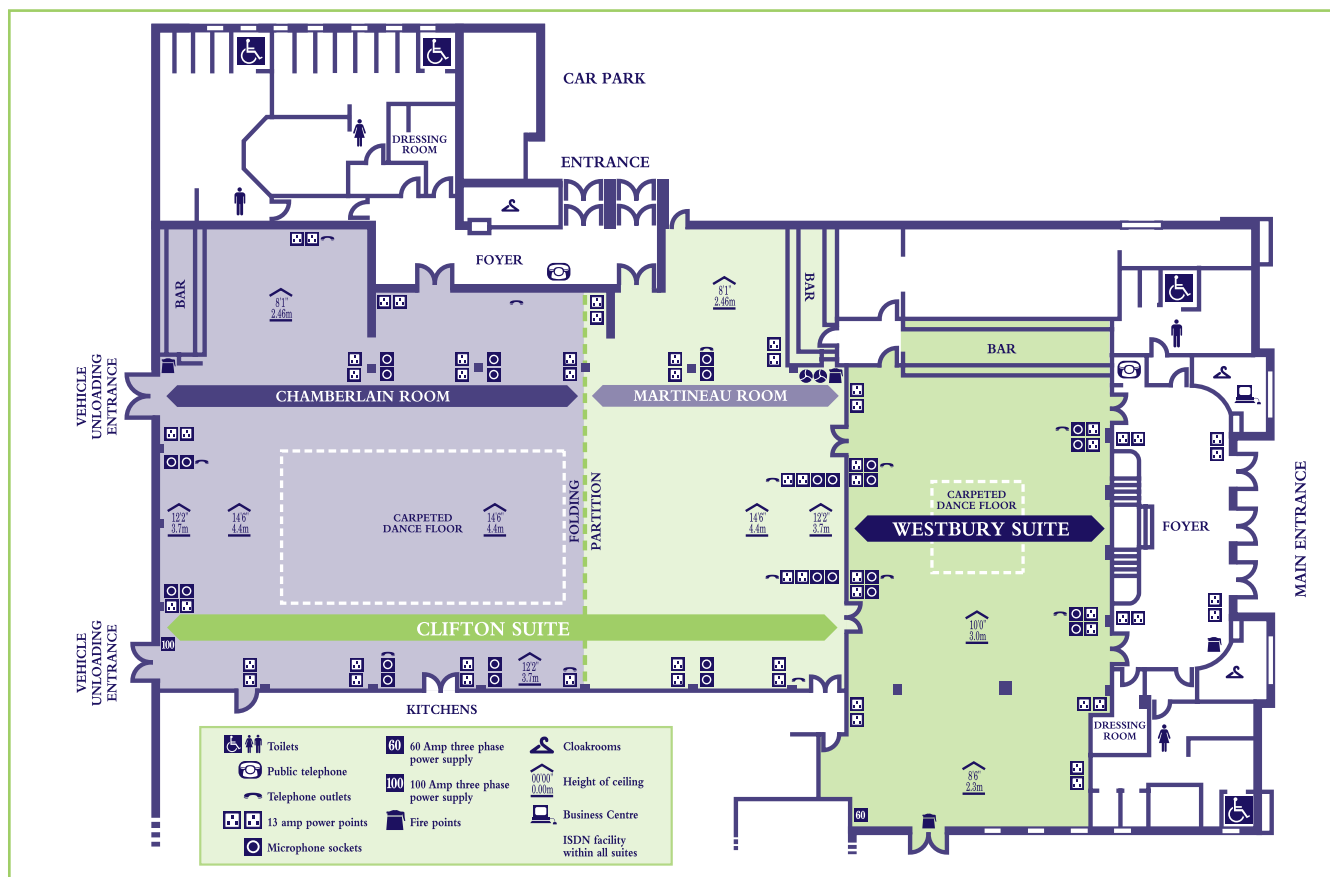

The Clifton Suite

Dimensions	Ft.Ins.	Metres
Length	104ft. 0ins.	31.6m
Width	69ft. 0ins.	21.1m
Area	7176 sq.ft	667 sq.m
Height (maximum)	14ft 6ins.	4.4m
Height (minimum)	12ft 6ins.	3.8m
Access door width	7ft 2ins.	2.09m
Access door height	7ft 6ins.	2.28m

Technical Data

3 phase supply	100 amps
13 amp power points	35
Telephone points	1

Capacities

Theatre	750
Theatre and back projection	600
Classroom	350
Cocktail party	1000
Oval tables	640
Formal tables	720
Dinner dance	550

The Westbury Suite

Dimensions	Ft.Ins.	Metres
Length	67ft. 6ins.	20.7m
Width	40ft. 0ins.	12.1m
Area	2700 sq.ft	250 sq.m
Height (maximum)	10ft 0ins.	3.0m
Height (minimum)	8ft 6ins.	2.3m
Access door width	7ft 2ins.	2.09m
Access door height	7ft 6ins.	2.28m

Technical Data

3 phase supply	60 amps
13 amp power points	16
Telephone points	1

Capacities

Theatre	250
Theatre and back projection	160
Classroom	125
Cocktail party	300
Oval tables	240
Formal tables	300
Dinner dance	200